



GPRS Stick Datalogger Quick Installation Manual

Version: 3.0



Delivery Content
■ 1 GPRS Stick
■ 1 GPRS Antenna
■ 1 Quick Installation Manual

1 Install the datalogger

The data collector is connected to the corresponding interface of the inverter. 5k inverter will be used as an example in this manual.
Please follow the instruction as below:

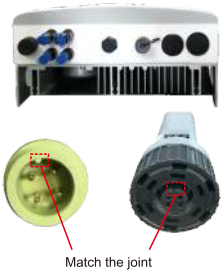

Install the datalogger:

1. Install the antenna to the datalogger
2. Insert the datalogger to the inverter COM port
3. Rotate the black circle clockwise

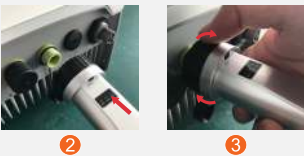

NOTE

Only rotate the black circle, not the silver cover.

NOTE

1. The device must be installed away from the strong magnetic field produced by large electrical appliances such as microwave oven, refrigerator, telephone, metal walls, etc. Otherwise, the communication quality may be affected. It may also be affected by lighting storm.
2. The [RESET] button on the back is used for connection.
-Short press will send the data immediately.
-Long press for 5 seconds will reset the connection.
The three constantly ON LED lights indicate the datalogger is working normally.

LED Lights Status:

LED indicators	Description	LED Status	Meanings
Internet Indicators ● (NET)	Shows the connection status between the datalogger and the server.	Flashing	Trying to connect with server
		ON	Successfully connected
		OFF	Abnormal connection
Inverter COM Indicators ● (COM)	Shows the connection status between datalogger and the inverter.	Flashing	Trying to connect with inverter
		ON	Successfully connected
		OFF	Abnormal connection
Power Indicator ● (PWR)	Shows the power supply status of the datalogger.	ON	Datalogger is powered up normally
		OFF	Datalogger is powered up abnormally

2 Create the Soliscloud Account

Step 1: Use you phone to scan the QR code to download and register the Solis Cloud APP. Or directly download from APP Store or Google Play Store by searching "SolisCloud".



Step 2: Open the APP and click register.

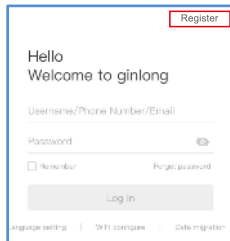

Step3: Select Owner or Installer for email address registration.

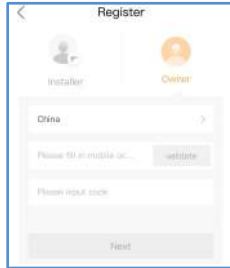

Step4: Enter your account and password, then click the "Register".

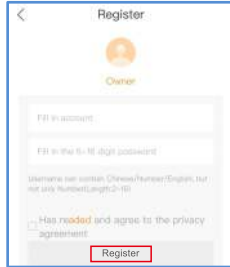

3 Create Plant

Step1: Enter the main page of Soliscloud APP, click the "Add plant" at the bottom.



Step 2: Input the information of the plant as required. Then click "Done".



Step 3: Confirm the plant information. Click "Create a plant".

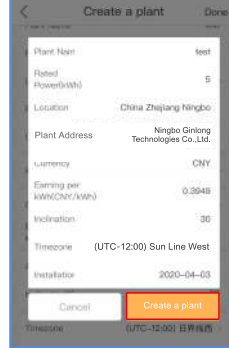

Step 4: Click "View plant" to enter the plant homepage, then add the datalogger.

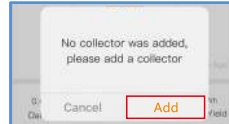
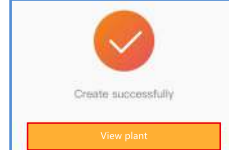

Step 5: Scan the SN number of the datalogger or manually input it.



Note: Scan the datalogger SN, NOT the inverter SN.



Step 6: Plant creation succeeds. Click "Continue...datalogger" to check the monitoring data. If the plant has multiple dataloggers, please click "View Plant".

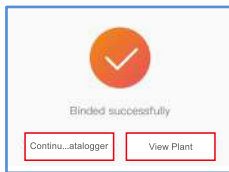

Contact

Please contact us if you have any technical problems in terms of the product. Please provide the following information as well:

- ◆ Inverter SN
- ◆ Datalogger SN
- ◆ Problem Description

Ginlong Technologies Co., Ltd.

No. 57 Jintong Road, Binhai Industrial Park, Xiangshan, Ningbo, Zhejiang, 315712, P.R.China.

Tel: +86 (0)574 6578 1806

Fax: +86 (0)574 6578 1606

Email : info@ginlong.com

Web : www.ginlong.com